

767 LP PORT CONNECTOR

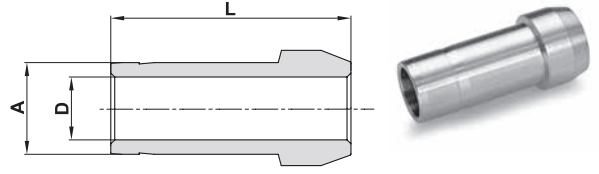

CONNECTS TWO LET-LOK® PORTS (METRIC)

Ordering Information	A Tube O.D.		D		L	
	inch	mm	inch	mm	inch	mm
767LP_3		3		2.1		22.2
767LP_6		6		4.0		25.0
767LP_8		8		5.6		25.9
767LP_10		10		7.1		27.1
767LP_12		12		8.8		36.2
767LP_16		16		12.7		37.4
767LP_18		18		13.9		37.4
767LP_38		*38		31.6		81.9
767LP_50		*50		42.8		114.0

CONNECTS TWO LET-LOK® PORTS (INCH)

Ordering Information	A Tube O.D.		D		L	
	inch	mm	inch	mm	inch	mm
767LP_1/16	1/16	1.58	.03	0.75	.54	13.7
767LP_1/8	1/8	3.17	.08	2.03	.88	22.4
767LP_1/4	1/4	6.35	.17	4.20	.98	24.9
767LP_5/16	5/16	7.93	.24	6.00	1.02	25.9
767LP_3/8	3/8	9.52	.27	6.85	1.03	26.2
767LP_1/2	1/2	12.70	.37	9.40	1.41	35.8
767LP_3/4	3/4	19.05	.59	15.00	1.47	37.3
767LP_1	1	25.40	.80	20.30	1.90	48.1
767LP_1 1/4	*1 1/4	31.75	1.02	26.00	2.72	69.1
767LP_1 1/2	*1 1/2	38.10	1.25	31.60	3.31	84.1
767LP_2	*2	50.80	1.72	43.67	4.56	115.8

Port Connector 767LP

Tighten the nut.

1-1/4 turns of the nut are required for 1/4" (6 mm) and higher.
A 3/4 turn of the nut is required for 3/16" (4 mm) and lower.

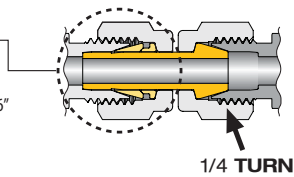

* Supplied assembled with Nuts and Ferrules. Low friction paste, see page 91
"D" - Dimension is minimum opening. Dimensions are for reference only, and are subject to change without notice.