

## 764 LR REDUCING TEE

HOW TO ORDER

764LR     $\frac{3}{8}$  X  $\frac{3}{8}$  X  $\frac{1}{4}$

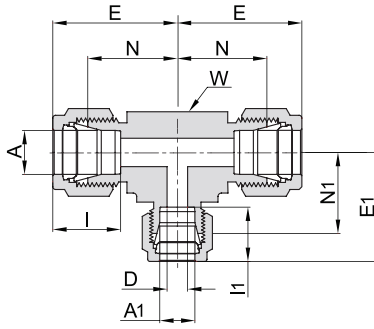
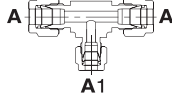

### ALL TUBE (METRIC)

Ordering Information	A		A1		E		E1		I		I1		D		W		N		N1	
	Tube O.D.		Tube O.D.		mm		mm		mm		mm		mm		Wrench Flat		mm		mm	
	mm	mm	mm	mm	mm	mm	mm	mm	mm	mm	mm	mm	mm	mm	inch	mm	mm	mm	mm	mm
764LR_8MMX8MMX6MM	8	6	29.9	29.8	16.2	15.3	4.8	5/8	15.9	22.4	22.4									
764LR_10MMX10MMX6MM	10	6	31.5	31.3	17.2	15.3	4.8	11/16	17.5	23.9	23.9									
764LR_12MMX12MMX6MM	12	6	36.0	31.8	22.8	15.3	4.8	13/16	20.6	25.9	24.4									
764LR_12MMX12MMX10MM	12	10	36.0	33.5	22.8	17.2	7.9	13/16	20.6	25.9	25.9									
764LR_14MMX14MMX10MM	14	10	38.8	36.3	24.4	17.2	7.9	15/16	23.8	28.7	28.7									
764LR_18MMX18MMX12MM	18	12	39.8	39.8	24.4	22.8	9.5	1 1/16	27.0	29.7	29.7									
764LR_50MMX50MMX38MM	*50	*38	106.0	96.2	65.0	49.4	33.7	2 3/4	69.9	68.9	68.6									

### ALL TUBE (INCH)

Ordering Information	A		A1		E		E1		I		I1		D		W		N		N1	
	Tube O.D.		Tube O.D.		inch		mm		inch		mm		inch		mm		inch		mm	
	inch	mm	inch	mm	inch	mm	inch	mm	inch	mm	inch	mm	inch	mm	inch	mm	inch	mm	inch	mm
764LR_1/4 X 1/4 X 1/8	1/4	6.35	1/8	3.17	1.06	26.9	1.03	26.2	.60	15.2	.50	12.7	.09	2.28	1/2	12.7	.77	19.6	.77	19.6
764LR_3/8 X 3/8 X 1/4	3/8	9.52	1/4	6.35	1.20	30.5	1.14	29.0	.66	16.8	.60	15.2	.19	4.82	5/8	15.9	.91	23.1	.85	21.6
764LR_1/2 X 1/2 X 1/4	1/2	12.70	1/4	6.35	1.42	36.1	1.25	31.8	.90	22.9	.60	15.2	.19	4.82	13/16	20.6	1.02	25.9	.96	24.4
764LR_1/2 X 1/2 X 3/8	1/2	12.70	3/8	9.52	1.42	36.1	1.31	33.3	.90	22.9	.66	16.8	.28	7.11	13/16	20.6	1.02	25.9	1.02	25.9
764LR_5/8 X 5/8 X 3/8	5/8	15.88	3/8	9.52	1.53	38.9	1.42	36.1	.96	24.4	.66	16.8	.28	7.11	15/16	23.8	1.13	28.7	1.13	28.7
764LR_3/4 X 3/4 X 1/4	3/4	19.05	1/4	6.35	1.57	39.9	1.46	37.1	.96	24.4	.60	15.2	.19	4.82	1 1/16	27.0	1.17	29.7	1.17	29.7
764LR_3/4 X 3/4 X 3/8	3/4	19.05	3/8	9.52	1.57	39.9	1.46	37.1	.96	24.4	.66	16.8	.28	7.11	1 1/16	27.0	1.17	29.7	1.17	29.7
764LR_3/4 X 3/4 X 1/2	3/4	19.05	1/2	12.70	1.57	39.9	1.57	39.9	.96	24.4	.90	22.9	.41	10.41	1 1/16	27.0	1.17	29.7	1.17	29.7
764LR_1 X 1 X 3/8	1	25.4	3/8	9.52	1.93	49.0	1.65	41.9	1.23	31.2	.66	16.8	.28	7.11	1 3/8	34.9	1.45	36.8	1.36	34.5
764LR_1 X 1 X 1/2	1	25.4	1/2	12.70	1.93	49.0	1.76	44.7	1.23	31.2	.90	22.9	.41	10.41	1 3/8	34.9	1.45	36.8	1.36	34.5
764LR_1 X 1 X 3/4	1	25.4	3/4	19.05	1.93	49.0	1.76	44.7	1.23	31.2	0.96	24.4	.62	15.75	1 3/8	34.9	1.45	36.8	1.36	34.5
764LR_1 1/4 X 1 1/4 X 1	*1 1/4	31.75	1	25.40	2.67	67.8	2.17	55.1	1.62	41.2	1.23	31.2	.88	22.35	1 11/16	42.9	1.75	44.5	1.69	42.9
764LR_1 1/2 X 1 1/2 X 1	*1 1/2	38.10	1	25.40	3.10	78.7	2.36	59.9	1.97	50.0	1.23	31.2	.88	22.35	2	50.8	2.00	50.8	1.88	47.8

\* Including low friction paste, see page 91

"D" - Dimension is minimum opening. Dimensions are for reference only, and are subject to change without notice.

Cont'd next page